

# Automatic Outboard Flushing System

## Instructions



### Table of Contents

General Overview .....	2
Electrical and Installation .....	3
Operation and Troubleshooting .....	4

### Contact Us

Reverso Pumps LLC  
4001 SW 47th Ave, Suite 201  
Davie, FL 33314  
Ph: (954) 522-0882  
customerservice@reversopumps.com  
www.reversopumps.com

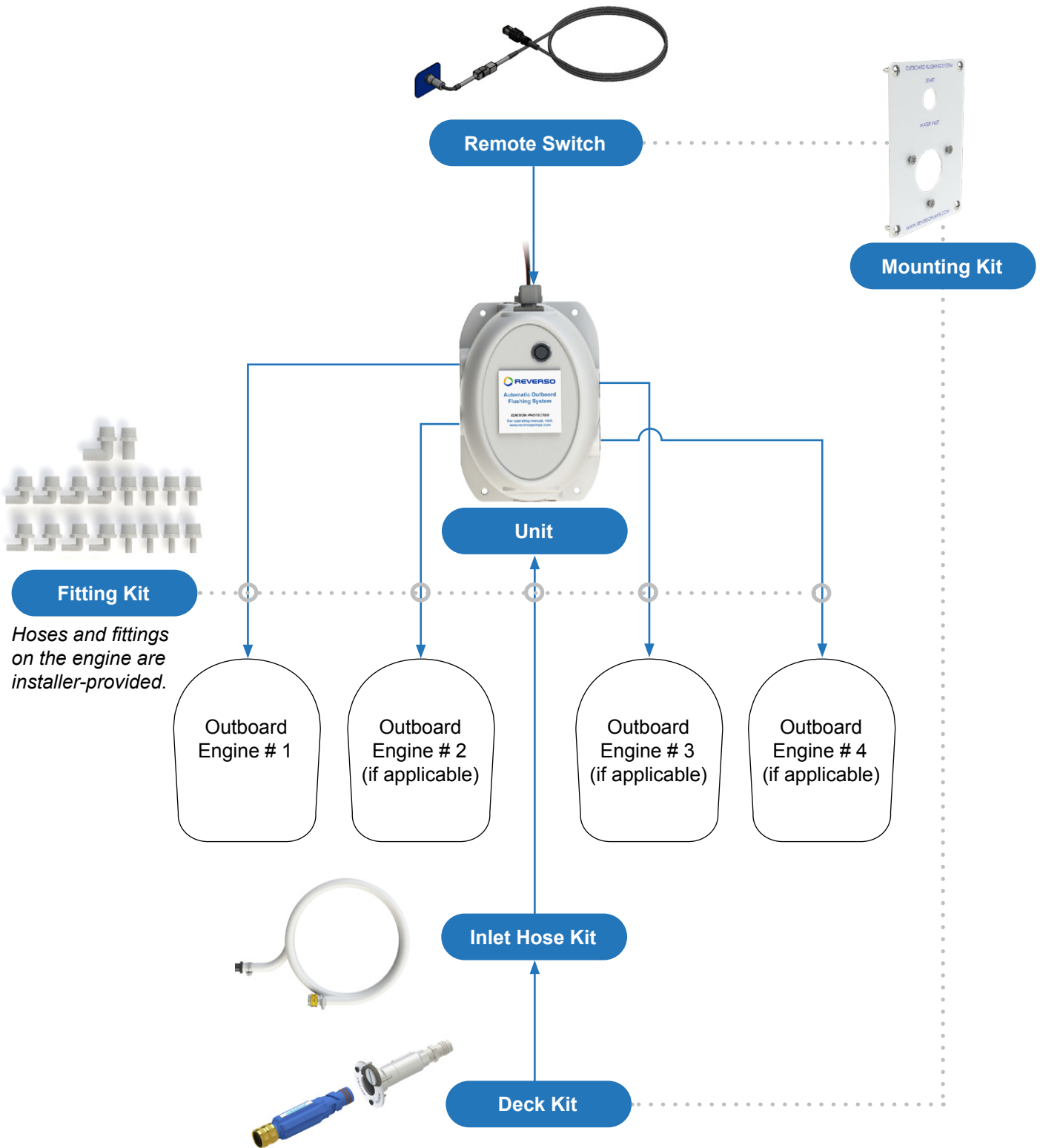

## Mounting Instructions

- Parts needed:
  - Four 3/16" screws (installer provided).
- Mounting holes: Ø 3/16"
- Unit must be mounted on a flat surface—to not bend the base of the unit. Bending the base will cause damage to the unit.
- Unit must be installed in as dry a location as possible. If unit is installed in the bilge area, it should be installed above the waterline and in the driest location.
- Unit must be installed with the power wires on top of the unit.
- Do not install upside-down.
- Unit should be installed in an area that is easily accessible for servicing.

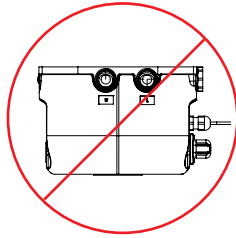

## Electrical Connections

- Parts needed: Waterproof connectors and 5A fuse (installer provided).
- Unit requires continuous supply of 12 volt power.
- To avoid the risk of harm or injury, make sure that the power supply is disconnected. Ensure that the power supply is at zero volts with a multimeter before making any electrical connections.
- Installation of unit should only be performed by qualified electrician who have thoroughly read and understands the installation instructions covered in this manual and adhere to ABYC requirements.
- Be sure that the power source available matches the power requirements.
- Installation must include protection with 5A fuse or breaker (not provided).
- Power wires must be connected using waterproof connectors.
- Only connect black (-) and red (+) wires to same respective color. Damage can occur to the system if these wires are crossed.

## Quick Disconnect Deck Kit, Quick Disconnect Mounting Kit, Remote Switch, and Inlet Hose Kit

- Parts needed:
  - Quick Disconnect Deck Kit
  - Quick Disconnect Mounting Kit
  - Remote Switch
  - Inlet Hose Kit
  - 1 1/2" and 3/4" drill bit
  - Screw driver
- Choose an easily accessible and convenient location to install Quick Disconnect Deck Kit, where the remote button and hose connection will be accessible. (Preferably: on a flat surface above the water line).

- Drill holes for Remote Switch and Quick Disconnect Deck Kit, which correspond to the Quick Disconnect Mounting Kit.
- Screw the Quick Disconnect Mounting Kit to the selected location.
- Install Quick Disconnect Deck Kit by placing silver part through 1 1/2" hole with Reverso label horizontal and secure with screws provided.
- Install Remote Switch by placing Remote Switch through the 3/4" hole and secure with nut provided.
- Connect one end of Inlet Hose to the Quick Disconnect Deck Kit and the other end of Inlet Hose to the Unit.
- Connect Deutsch connector end of Remote Switch to the harness and connect the other end of the harness to the Unit.

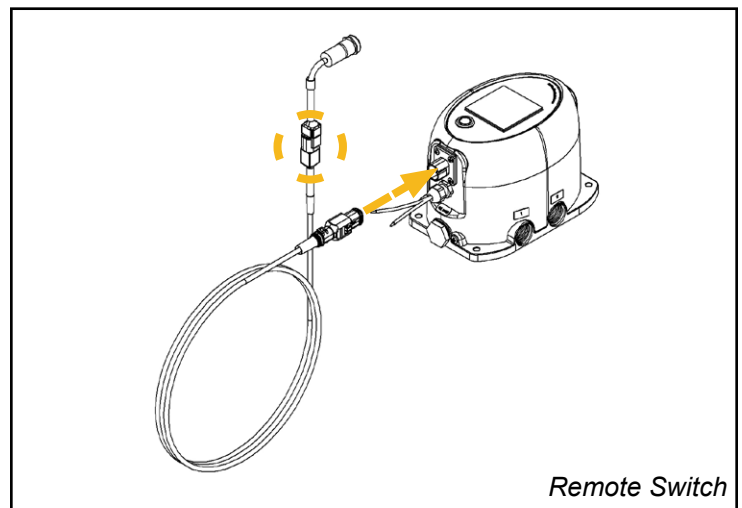

## Engine Hose Connections and Fitting Kit

- Parts Needed:
  - 3/8" inner diameter reinforced hose (1/2" inner diameter reinforced hose is required for engines over 300 horsepower). (Installer provided)
  - Fitting Kit
- Connect barb fittings to outlet ports of Unit using teflon tape or plastic thread sealant. Tighten to 40 in-lbs.
- Connect one end of each hose to barb fitting, and clamp hose with worm gear hose clamp.
- Run other end of hose through the cowling to each engine, connect to flush hose in engine, and clamp hoses with with worm gear hose clamp.

## Initial Setup

- The system will not work without adequate water pressure.
- LED button should be solid red when water is not connected.
- Connect freshwater hose to the installed Quick Disconnect port or Unit.
- Turn on water. Solid red light on LED button should go away.
- The system is now ready to flush your engines.

## Operation

### 15 Minutes Mode:

1. Push LED button once to enter 15 Minute mode and LED button will turn **solid blue**.
2. Engine will flush one at a time for 15 minutes until the last engine is flushed.
3. Once the last engine is flushed, the Unit will automatically shut itself off.
4. To terminate flush during operation, press the LED button twice to stop.

### 7.5 Minutes mode:

1. Push LED button twice to enter 7.5 Minute mode and LED button will turn **flashing blue**.
2. Engine will flush one at a time for 7.5 minutes until the last engine is flushed.
3. Once the last engine is flushed, the Unit will automatically shut itself off.
4. To terminate flush during operation, press the LED Button twice to stop.

### Service Mode:

1. To enter the Service Mode, hold down button for 5 seconds until the LED **flashes blue** and then turns off. This indicates you have entered maintenance mode.
2. The Service Mode will only cycle through the amount of engines on the vessel. To **manually** cycle through engines, press the button once for each engine.
  - a. The first press will flush engine 1. LED light flashes from blue to red once.
  - b. The second press will switch to engine 2 (if applicable). LED light flashes from **blue to red** 2x.
  - c. The third press will switch to engine 3 (if applicable). LED light flashes from **blue to red** 3x.
  - d. The fourth press will switch to engine 4 (if applicable). LED light flashes from **blue to red** 4x.
3. On the last engine, press once to end. The button will flash alternating red/blue for 5 seconds, then will return to ready state for normal operation..
4. To exit Service Mode at any time, hold down button for 5 seconds until it **flashes red**.

### Winterizing Unit

1. Connect hose which will supply winterizing fluid to installed Quick Disconnect port or Unit.
2. Place Unit in Service Mode and run winterizing fluid through each engine.

## Troubleshooting

- No LED light – No power to the Unit.
  - Use a multimeter to confirm that 12 volts is going to the Unit.
  - Check that Black and Red wire are connected properly to power supply.
  - Check to see if there is an inline fuse and if so, that fuse is not blown.
  - If connected to battery, check that battery is fully charged, and providing 12V to the Unit.
- LED Light is solid red – Low pressure or no water going to the Unit.
  - Check that sufficient water pressure is at water source and water is getting to the Unit.
  - Check inlet hose to ensure that there are no bends or kinks in the hose that might be causing decreased water pressure.
  - Confirm that all fittings are properly installed to the Unit.
  - If using Quick Disconnect, disconnect Quick Disconnect from hose and look inside of blue Quick Disconnect and ensure there is nothing obstructing water from flowing through.
- LED Light is flashing red – Unit is under/over voltage or there is a control board failure.
  - Use a multimeter to confirm 12 volts is going to the Unit.
  - If 12 volts is present, possible control board failure. Contact Reverso.

## Warranty

To view the latest version of the policy, visit: [www.reversopumps.com/warranty-policy](http://www.reversopumps.com/warranty-policy)