

Part #	Description
35-3954-01	3' harness assembly
35-3954-02	6' harness assembly
35-3954-03	9' harness assembly
35-3954-04	12' harness assembly
35-3954-05	15' harness assembly
35-3954-06	18' harness assembly

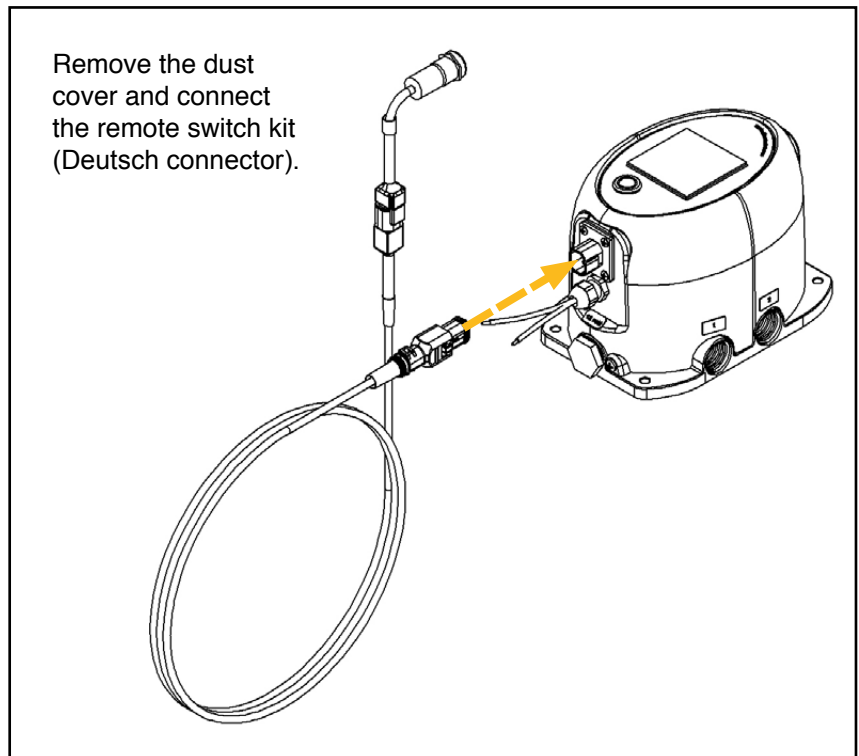

1. Pull back the boot from the male Deutsch connector to insert the remote switch through the mounting easier.



2. Put nut onto remote switch. Use flat head screw driver to assist. Slide boot back over the connector.

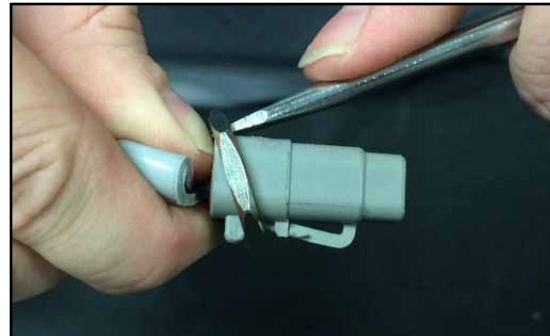

3. Slide the nut up the cable and tighten nut clockwise to secure switch.



4. Connect Deutsch connector.

