

Diesel Tech Polisher

INSTRUCTIONS

Quick Operation Guide

- 1 Insert suction and return hose into the tank.
- 2 Connect battery clips to power.
- 3 Drain water and disconnect after use.

Operation Notes

- Do not run pump dry.
- Do not operate unattended.
- For diesel fuel only. **Not for use with gasoline.**

Troubleshooting

Issue	Possible Causes and Action
Low / No Flow	<ul style="list-style-type: none"> • Check if suction hose is stuck to the bottom of tank. • Verify voltage and fuse. • Prime the pump and filter. • Pump is worn. Inspect gears. • Air leak. Inspect lines and seals.
Rapid pump wear	<ul style="list-style-type: none"> • Pump has been run dry. Ensure sufficient fuel supply.
Noisy operation	<ul style="list-style-type: none"> • Ensure sufficient fuel supply. • Air in the suction hose. Check hose is submerged in the fuel or check for leak.
Electrical	<ul style="list-style-type: none"> • Verify voltage and fuse.

Models

Part #	Model	Voltage	Amp	Fuse
83-1000-01	DTP-50	12V	2.7A	10A
83-1001-01	DTP-90	12V	5A	10A
83-1002-01	DTP-125	12V	7.5A	10A

Spare Parts

Part #	Replacement Elements	Models
87-1961	10 micron	DTP-3-12 DTP-3-24
87-1962	6 micron	
87-1963	3 micron	
87-1960	10 micron	DTP-8-12 DTP-8-24
87-1964	6 micron	
87-1965	3 micron	
58-01010	10 micron	DTP-10-12 DTP-10-24
58-01030	30 micron	
58-01060	60 micron stainless	

Model DTP-50 and DTP-90 Service the filter only while the system is off.

Draining The Filter

- 1 Visually check the water level regularly. The filter must be drained when the water reaches maximum level, or when the pumps like it's straining.

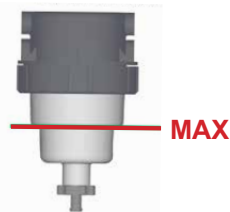

- 2 Twist the valve left to drain. Twist right to close, and dispose appropriately.

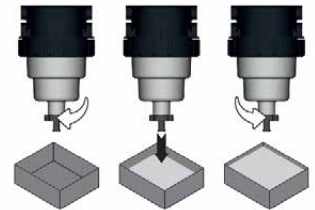

Replacing The Element

- 1 Visually check the condition of the element regularly. Empty the filter.

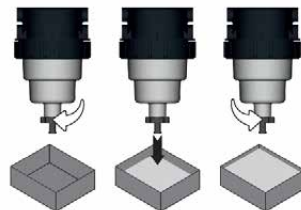

- 2 While holding the container, loosen bayonet ring with a quarter-turn and remove.



- 3 Dispose of the used element and insert new element.

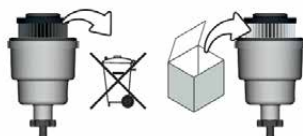

- 4 Assemble container and bayonet ring. The system is ready for use.



Model DTP-125 *Service the filter only while the system is off.*

Draining The Filter

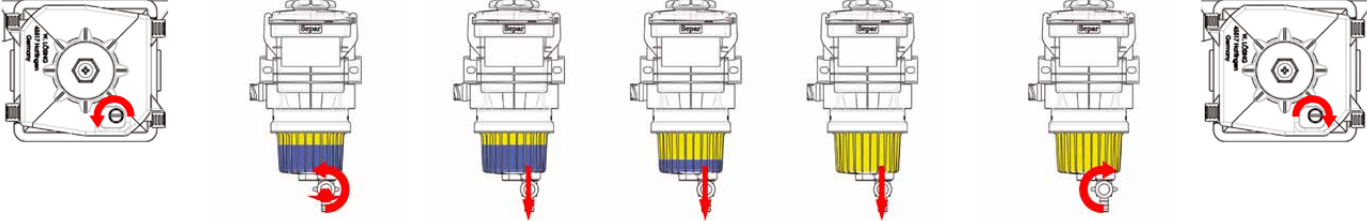
- 1** Loosen the bleed screw on the lid by two rotations.
 - 2** Pull the handle of the drain valve towards you and open it by a quarter-turn counterclockwise.
 - 3** Drain the water and leave the bowl filled with diesel fuel only.
 - 4** Close the drain valve by turning the handle clockwise until it snaps into place.
 - 5** Tighten the bleed valve on the lid. The system is ready for use.
- 

Replacing The Element

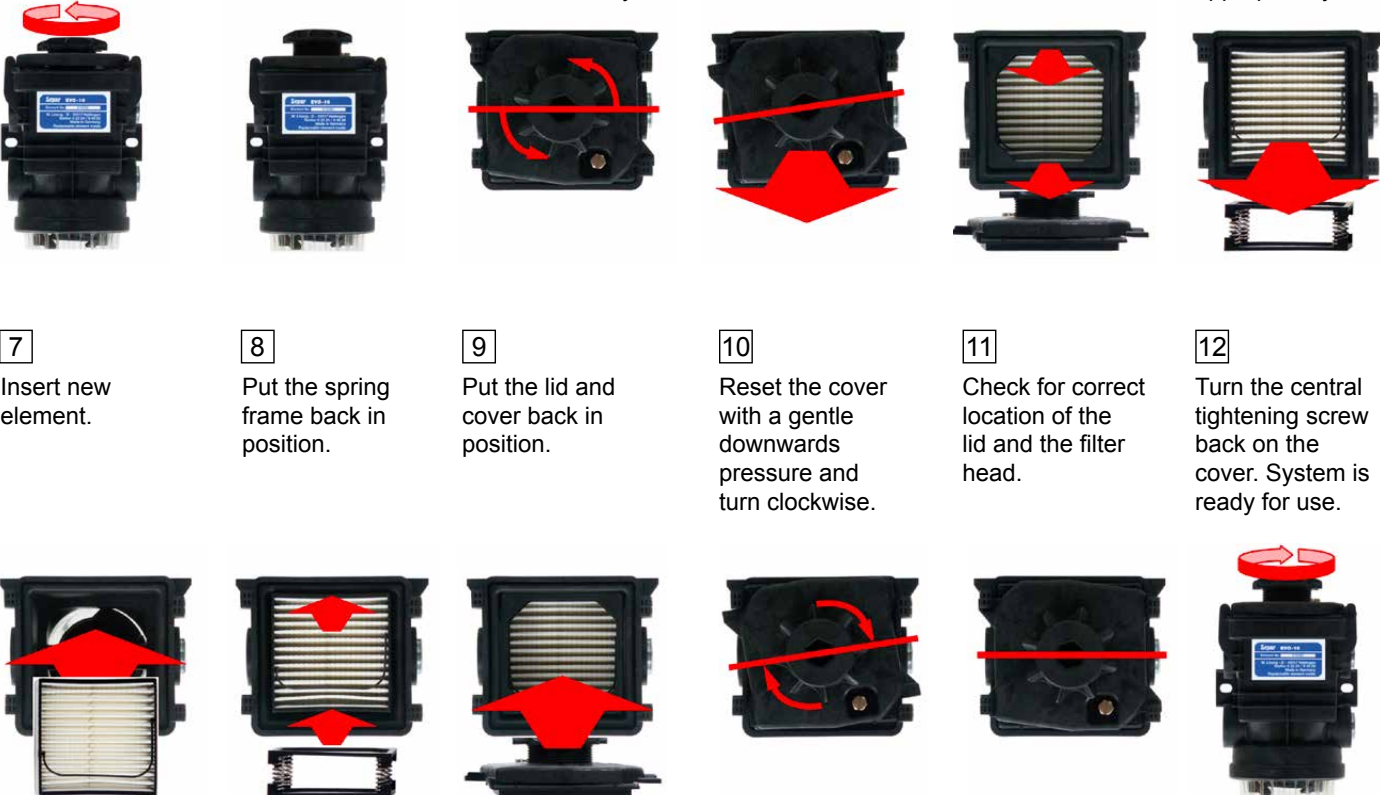
- 1** Loosen the central tightening screw on the cover.
 - 2** Turn it until it reaches the stop position.
 - 3** Release the lid with gentle pressure and rotate counterclockwise to free it of the bayonet.
 - 4** Remove the lid and cover from the filter housing.
 - 5** Remove the spring frame.
 - 6** Pull out the used element by the handle, and dispose appropriately.
 - 7** Insert new element.
 - 8** Put the spring frame back in position.
 - 9** Put the lid and cover back in position.
 - 10** Reset the cover with a gentle downwards pressure and turn clockwise.
 - 11** Check for correct location of the lid and the filter head.
 - 12** Turn the central tightening screw back on the cover. System is ready for use.
- 

Version 12/10/2021