

Gear Pump 212

Gear pump suitable for diesel fuel, oil, and water transfer in intermittent usage.

Basic Features

- Self-priming
- IP65 rated
- Available in 12V and 24V

Optional Features

- On/off switch
- Reversing switch



Shown with optional switch

Technical Specifications

Flow Rate	1.9 GPM / 7.2 LPM	
Voltage	12V or 24V	
Ports	3/8" Male NPT	
Max. Work Pressure	50 psi / 3.5 bar	
Max. Work Temperature	205°F / 96°C	
Max Intermittent Temperature	221°F / 105°C	
Max. Amp. Draw	19A / 12V, 10A / 24V	
Pump Type	Gear	
Body	Brass	
Gears	Helical bronze	
Shaft	Stainless steel	
Seal	Fluoroelastomer lip seal	
Self-Priming	3 ft / 1m (wet gears)	
Dimensions GP-212	A	6.5" / 165 mm
	B	3.9" / 99 mm
	C	3.4" / 86 mm
Dimensions GP-212S GP-212R	A	7.75" / 197 mm
	B	3.9" / 99 mm
	C	3.4" / 86 mm

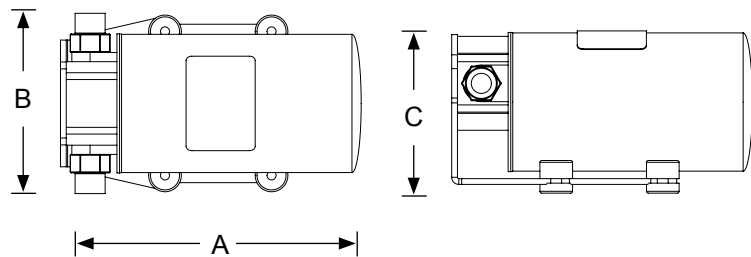

Pressure (psi)	Flow Rate (GPM)	Amp (A)
0	1.9	1.5
10	1.8	1.4
20	1.6	2.3
30	1.4	2.8
40	1.3	3.5
50	1.3	4

