

Impeller Pump OP Series

- Suitable for oil, diesel fuel, or water
- Transfers hot or cold oil quickly and cleanly to and from the oil pan
- 3-Position switch (On-Off-On)
- Safety lock prevents accidental activation
- Easy operation: Flow is in direction of switch

Technical Specification

Ports	(Ext) M 3/4" Hose (Int) F 3/8" NPT
Max pressure	15 psi
Amp. Draw	7A@12V, 3A@24V
Flow Rate	3.0 GPM (11.35 LPM)
Impeller	Nitrile (Standard), Fluoroelastomer (Optional)
Self priming	3 ft (0.91 m)
Lift	10 ft (3.05 m)
Seal	Nitrile (Standard), Fluoroelastomer (Optional)
Motor	12V or 24V DC
Fuse	15A@12V, 10A@24V

Impellers & Gaskets

360010	Impeller (Nitrile) use for oil or water transfer
360014	Impeller (Fluoroelastomer) use for diesel fuel transfer
360120	Gasket for OP-6

Repair Kits: Impeller + Gasket Set

SRK-360	1 Oil/water set
SRK-370	1 Diesel/oil set

Rebuild Kits: Impeller + Gasket + Seals Set

SRK-361	1 Oil/water set
SRK-371	1 Diesel/oil set

Model	A	B	C	Weight
OP-6	9.46" (240.3mm)	4.29" (109mm)	3.5" (88.9mm)	4.5 lbs (2.04 kg)
OP-6FV	9.46" (240.3mm)	4.29" (109mm)	3.5" (88.9mm)	4.5 lbs (2.04 kg)

Part Number	Description
OP-6-12	12 Volt
OP-6-24	24 Volt
OP-6FV-12	12 Volt, Fluoroelastomer impeller
OP-6FV-24	24 Volt, Fluoroelastomer impeller

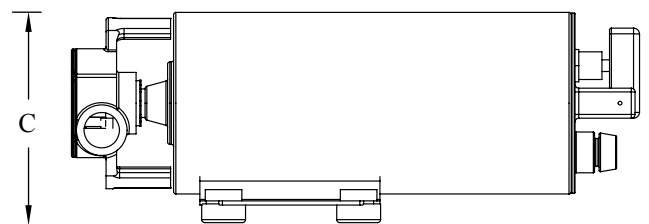
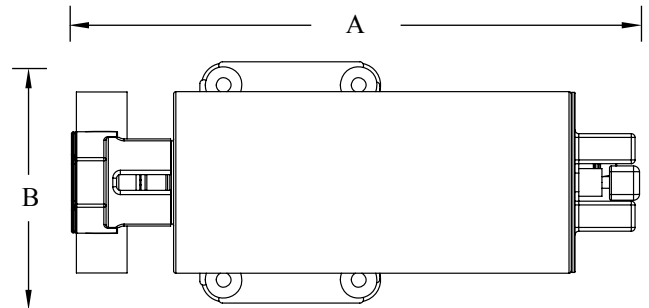

Drawing dimensions for reference only
Technical drawings available upon request.

Shown: OP-6-12

Inside the OP-6

- Reversible
- Self-priming
- Chrome plated brass head
- Built in switch guard
- Fused at the motor
- Easily changed Impeller
- "CE" certified

