

Gear Pump 201

Self-priming electric pumps with helical bronze gears for transferring lubricating oils and viscous liquids. Nickel-plated brass body and stainless steel shaft. Designed for intermittent use. Main applications: draining engine sumps and lubricating engines.

Basic Features

- Low flow
- Self-priming
- Reversible flow
- Available in 12V and 24V
- Rated IP67

Compatible Fluids

- Fresh water (max 85°F)
- Engine oil and non-corrosive viscous liquids (max viscosity 350 cSt)
- Diesel fuel (min. flashpoint 131°F)



Technical Specifications

Flow Rate	1/2" I.D. Hose	0.9 GPM / 3.4 LPM
Voltage	12V or 24V	
Ports	3/8" Male NPT	
Min. Ambient Temperature	14°F / -10°C	
Max. Ambient Temperature	140°F / 60°C	
Amp. Draw	2.3-2.7A / 12V 1.1-1.4A / 24V	
Fuse	3A / 12V 1.5 A / 24V	
Pump Type	Gear	
Body	Nickel-plated brass	
Gears	Helical bronze	
Shaft	Stainless steel	
Self-Priming	4.9 ft / 1.5 m (wet gears)	
Dimensions	A	5" / 128 mm
	B	4.4" / 112 mm
	C	3" / 76 mm
Weight	2.6 lbs / 1.2 kg	

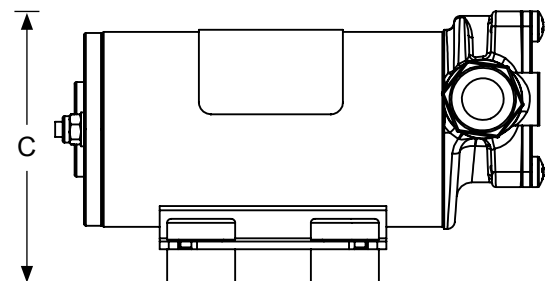
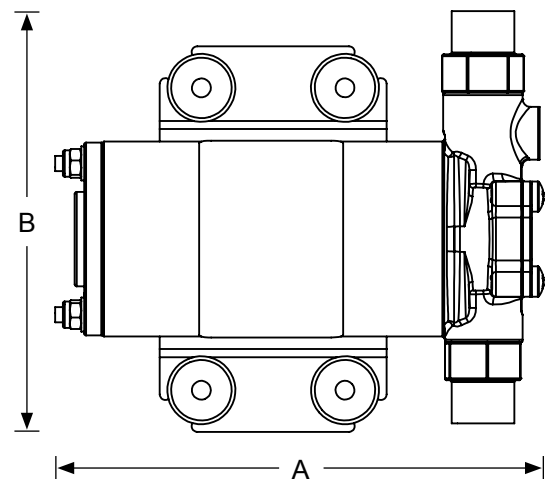

Version 9/6/17